



Item	CHARACTERISTICS	Unit	EWC-T-D-R-1000-2015
1	Manufacturer		EWC
2	Rated power	kVA	1000
3	Rated frequency	Hz	50
4	Rated. MV wind. voltage	kV	11
5	Steps of regulation on the MV side off-load	%	± 2 x 2,5
6	Rated LV wind. Voltage No-load	kV	0,416
7	MV/LV wind. connections		Delta/star+N
8	Vector group		Dyn11
9	Max altitude on the sea level	m	1000
10	Min. ambient temperature	°C	-5
11	Max ambient temperature	°C	50
12	Average yearly ambient temperature	°C	30
13	Type of installation		Indoor
14	Type of cooling		AN / AF
15	Dielectric		Epoxi-resin
16	Construction standards		IEC 60076-11
17	Isolation class of MV windings	kV	12/28/75
18	Isolation class of LV windings	kV	1,1/3
19	Thermal class of isolement		F
20	Average temp rise of HV/MV windings	°C	90
21	Max temp magn. core	°C	90
22	No-load losses to Vn	W	2300
23	No-load current to Vn/110% Vn	%	1.2
24	Load-losses ref. To 75°C	W	9800
25	Impedance ref. To 75°C	%	6
26	Sound Power level	dBA	77
27	Efficiency		
	100% Pn cos φ= 1	%	98.81
	75% Pn cos φ= 1	%	98.97
	50% Pn cos φ= 1	%	99.06
28	Total weight	Kg	2400
29	Dimensions: in plant (LxP)	mm	1550x1000
	Height (H)	mm	1910
	Interdistance of wheels (I)	mm	820

Fittings and Accessories:

- Dial electronic thermometer with two electric. n.o. contacts.
- n.3 thermal resistance tp.PT 100 with junction electrical box.

Other Accessories:

- On demand.

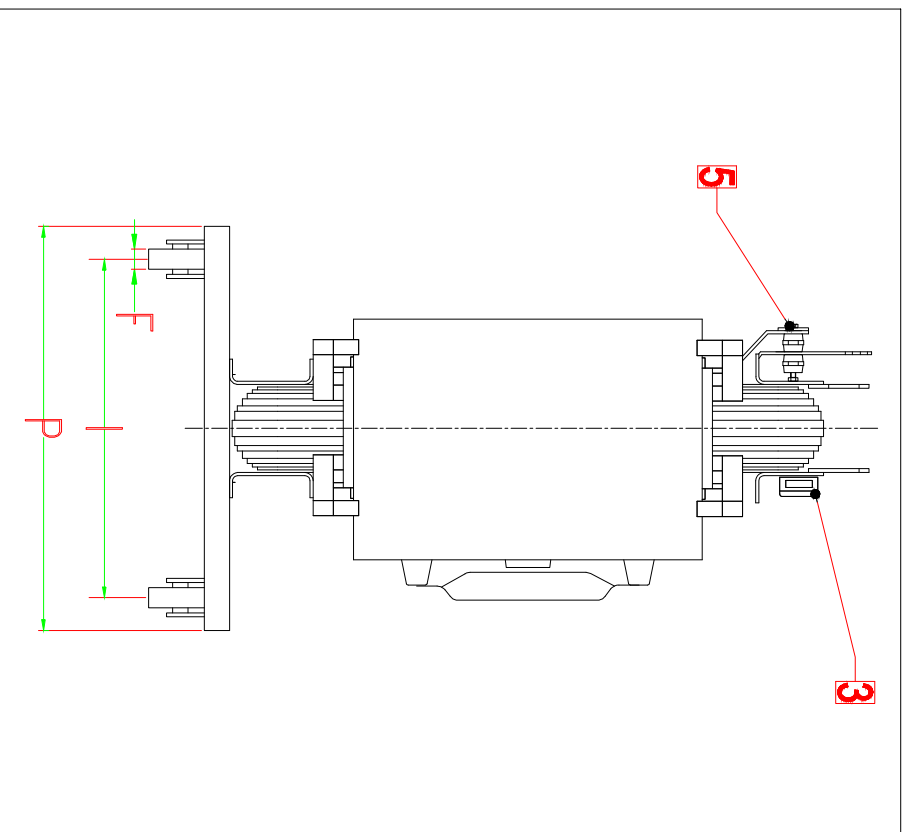

Pos. 7 - No Scala

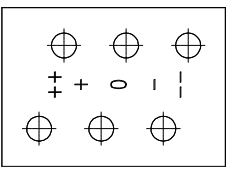

Description / Descrizione	
Raffreddamento / Cooling	AN
Potenza / Power	1000 kVA
Tensione / Voltage	11/0,416 kV
Gruppo / Connection Sym.	Dyn11
Frequenza / Frequency	50 Hz
Peso Totale / Total weight	2400

Pos.	Descrizione / Description	N°
1	Golfari di sollevamento / Lifting lugs	4
2	Terminale B.T. / Low voltage terminal	3
3	Scatola connessioni / Connection box	1
4	Targa caratteristiche / Rating plate	1
5	Terminale neutro / Neutral Terminal	1
6	Terminale primario / High voltage Terminal	3
7	Morsetteria variazione 1° / Variation clamp 1°	3
8	Attacchi per traino / Couplers	8
9	Morsetto di messa a terra / Earthing clamp	2
10	Carrello reversibile / Trolley for shifting	2

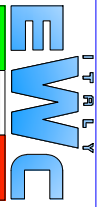

REGIONE REGION	00	EMISSIONE DESCRIPTION	T. AL-SALUHI MODELLO MODEL	T. AL-SALUHI CONTROLLO CHECKED	T. AL-SALUHI APPROVATO APPROVED
DATA DATE					

EWC GROUP srl

CLIENTE CUSTOMER	TITOLO TITLE	DESCRIZIONE DESCRIPTION	DATA DATE
	Car rain Dia. 1000 kVA - 11/0,416kV	1000 kVA - 11/0,416kV	2011

A. TERRELLI & C. S.p.A. - VIA S. GIUSEPPE, 10 - 20139 MILANO - TEL. 02/57491 - FAX 02/57492111 - WWW.ETERRELLI.COM